

Retained trees and vegetation to be protected through duration of project in accordance with BS5837:2012 (RPA indicated) As included within scheme Arboricultural Method Statement (AMS)

Existing vegetation requiring pruning or crown lifting works to facilitate access. Works within RPA of tree to be undertaken under supervision of Project Arboriculturalist.

Existing grassland and vegetation to be protected and retained. Where appropriate proposed grassland to be graded into existing levels.

Grass seeding  
(See ENV0000489C-JAC-ZZ-4AF-DR-PL-1408)

Areas of species rich spring flowering grassland/meadow - seeded with Cumbria Wildflowers Neutral Meadow Mix to be graded into existing retained grassland (allowing for settlement).

Areas of amenity grassland to minimum 1m verge to either side of footpath, to tie into existing grass levels (allowing for settlement). Seeded with Germinal Seeds A22 mix.

Planting  
(See ENV0000489C-JAC-ZZ-4AF-DR-PL-1405 & 1408/1409)

Semi Mature Tree planting with below ground guying. Root barrier required in proximity to proposed flood defences and existing services.

Key Plan:

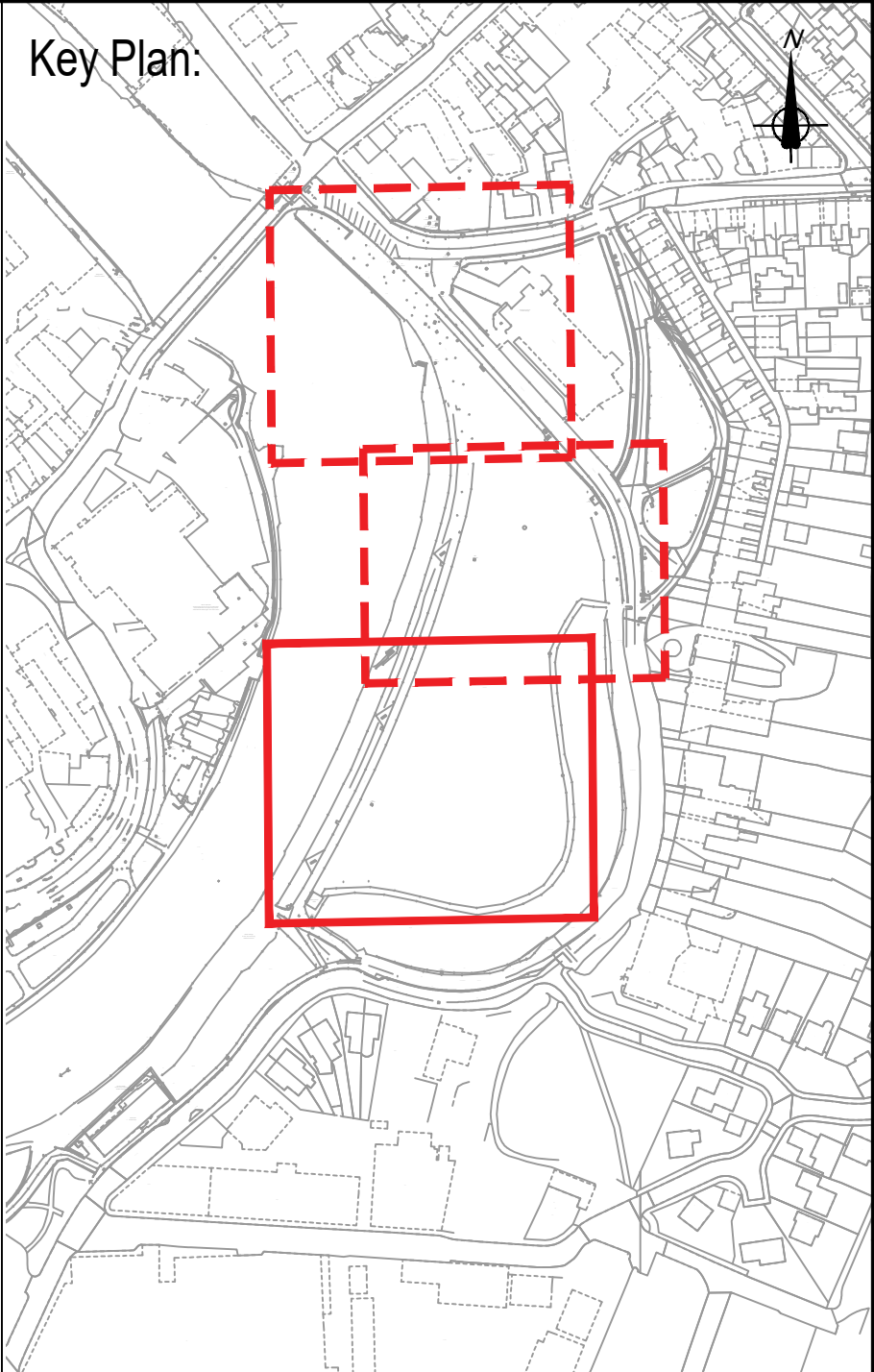

- All levels are shown in meters Above Ordnance Datum (Newlyn) unless stated otherwise.
- All dimensions are in millimetres unless stated otherwise.
- For supporting landscape proposals see drawings ENV0000489C-JAC-ZZ-4AF-DR- PL-1401 and 1402 - Landscape plan ENV0000489C-JAC-ZZ-4AF-DR- PL-1404 to1405 -Tree planting plans ENV0000489C-JAC-ZZ-4AF-DR- PL-1406 to1409 - Planting and Seeding plans ENV0000489C-JAC-ZZ-4AF-DR- PL-1410 - Tree protection plan
- All proposals subject to utility search
- All imported topsoil to comply with BS3882:2015
- All plant material to comply with BS3936:1992 Part 1 and BS5236
- Lifting, handling and delivery will be the responsibility of the contractor and should be carried out in accordance with plant handling specification issued by CPSE
- All works within RPA to retained trees to be undertaken by hand and with prior approval of project arboriculturalist.

P01	26/02/22	Planning for review and comment	GR	AM	AR	EM	
Rev	Rev. Date	Purpose of revision	Drawn	Checked	Rev'd	Appr'd	

European Union  
European Regional  
Development Fund

**Jacobs**

5 First Street, Manchester, M15 4GU  
Tel: +44 (0) 161 235 6000 Fax: +44(0)161 235 6001  
www.jacobs.com

Client

Project  
KENDAL FLOOD RISK MANAGEMENT SCHEME 1

Drawing title  
Reach F (F4)  
Landscape plan  
Sheet 3 of 3

Drawing status	S3	
Scale	As Shown	DO NOT SCALE
Jacobs No.	B228P023	Rev
Client no.	ENV0000489C	P01

Drawing number  
ENV0000489C-JAC-ZZ-4AF-DR-PL-1403

© Copyright 2022 Jacobs U.K. Limited. The concepts and information contained in this document are the property of Jacobs. Use or copying of this document in whole or in part without the written permission of Jacobs constitutes an infringement of copyright. Limitation: This drawing has been prepared on behalf of, and for the exclusive use of, Jacobs' Client, and is subject to, and issued in accordance with, the provisions of the contract between Jacobs and the Client. Jacobs accepts no liability or responsibility whatsoever for, or in respect of, any use of, or reliance upon, this drawing by any third party.

