

Rochdale and Littleborough Flood Risk Management Scheme

24 April 2024

Dear Resident,

Reference – Littleborough FRMS Phase 1B – Grove Lodge - Ground Investigation Works

Flood Defences proposed at this location

The Environment Agency is proposing to construct a new sheet piled flood defence wall alongside the railway. This defence is set back from the River Roch to allow flooding of the woodland area during storms. The Scheme is also proposing some habitat improvements including changes to the riverbanks to encourage more frequent wetting, which will help to form habitats such as wet woodland. Measures to make the area more attractive for otters and other wildlife, such as bats and birds, are also planned. A plan showing the extent of our works is on the next page and is available on the Rochdale Borough Council planning portal.

We're now planning to start our works in widening the entrance to Grove Lodge and conduct some more ground investigations to support the design of the flood defences required in this area.

What will we be doing?

- We will be widening the entrance to Grove Lodge and removing some of the wall as per our planning application (planning application 22/00485/FUL).
- We will be constructing an access ramp from Todmorden Road to the River Roch South of Grove Lodge to allow us to construct the flood defences.
- We will be conducting some ground investigations such as bore holes and trial holes at the river; this is constrained by a working window for in river working due to the ecology in the river.

How may this affect you?

- We will be installing traffic management on Todmorden Road whilst we build this road and entrance.
- Whilst we work on the footway a pedestrian walkway will be provided.
- We have also closed the footpath at Grove Lodge and recently removed trees in order to facilitate this work.
- **The traffic management on Todmorden Road will be in place from 29 April 2024 and will be in place for around 9 weeks whilst we complete these works.**
- These lights will be manually controlled between the hours of 7am and 7pm Monday to Friday.
- You may notice some machinery and equipment in the area whilst we carry out these works.

- You may see an increase in construction vehicles and wagons as we bring in equipment and material to site, during the construction works we will do what we can to keep any noise to a minimum.

The plan for our traffic management is shown below showing the location of our works and planned traffic management.

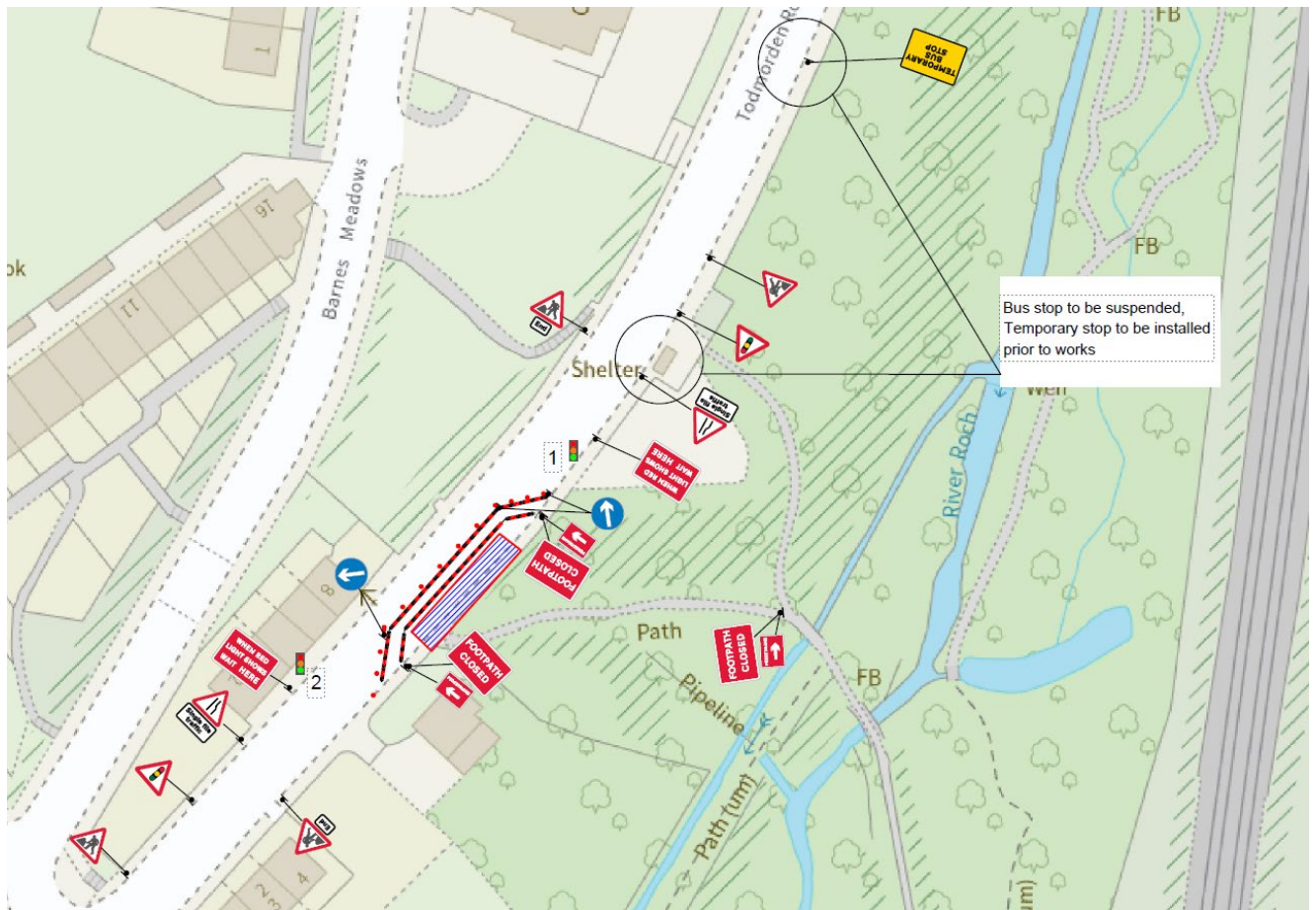

Should you wish to contact us regarding these works please email rochdaleandlittleborough.FAS@environment-agency.gov.uk or alternatively more information can be found at www.thefloodhub.co.uk/rochdale-and-littleborough/.

Kind regards,

Customer Services

VolkerStevin

