

Kendal Flood Risk Management Scheme

Reducing flood risk in your community

Waterside Café has been closed for around seven weeks, to protect public safety in that area. The café has been closed from 19 May while the greatest impact from the works will take place. This is due to the proximity of substantial plant and machinery and the potential impacts that will have on the café and their customers. A compensation package is being provided to ensure they are remunerated for the closure.



As work continues to construct the foundations for new glass panel flood defences at Waterside in Kendal, the riverside footpath will continue to remain closed for the duration of the works.

Footpath diversion

For Health and Safety, the closer of a section of the footpath during the works.  Footpath diversions will be in place.

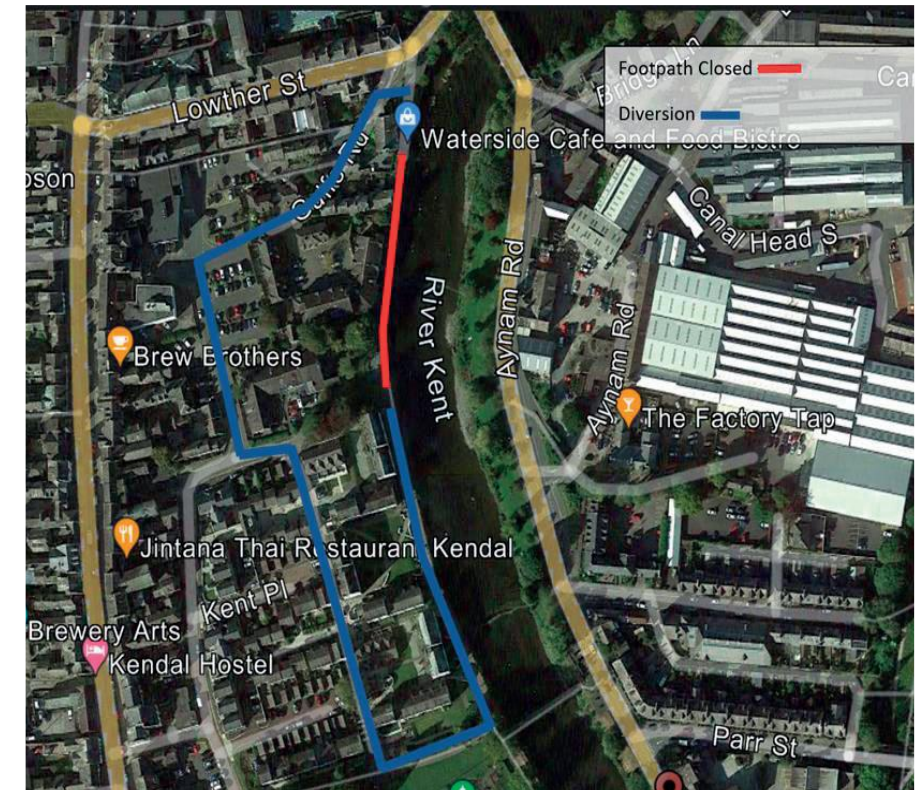



Piling using Spiral Flush method

What are we doing?

Piling works have started along the river, The piling is in front of the existing wall to construct a flood defence wall. The Spiral flush method of piling is used to pile a casing down into the ground before filling with concrete. In this area the piling will be between 6.5m – 9.8m deep. The casing will be a minimum of 2.25m deep into bedrock to prevent water rising underground.

We are constantly reviewing noise and vibration data, Undertaking visual and structural surveys of the riverside wall and road. Camera's are used to complete drain surveys also looking for any disturbances. Water sampling in the river, ensuring levels of silt are kept to a minimum, protecting fish and wildlife.

The process of works involves collaboration with the Environment Agency, WSP design team, VolkerStevin delivery contractor, VGE, and Kellers, the piling specialists.

The next steps will include;

- Piling has commenced near Edgecombe Court working upstream towards Miller Bridge.
- Pouring the concrete foundations and wall working back down stream towards Edgecombe Court.
- Wall to be cladded
- Glass panels to be erected.
- Noise and Vibrations will be monitored during the construction period.
- Footpath closure during construction



Sound and Vibration Monitoring



Drain surveys

Kendal Flood Risk Management Scheme

Waterside progress as of 9th June 2025

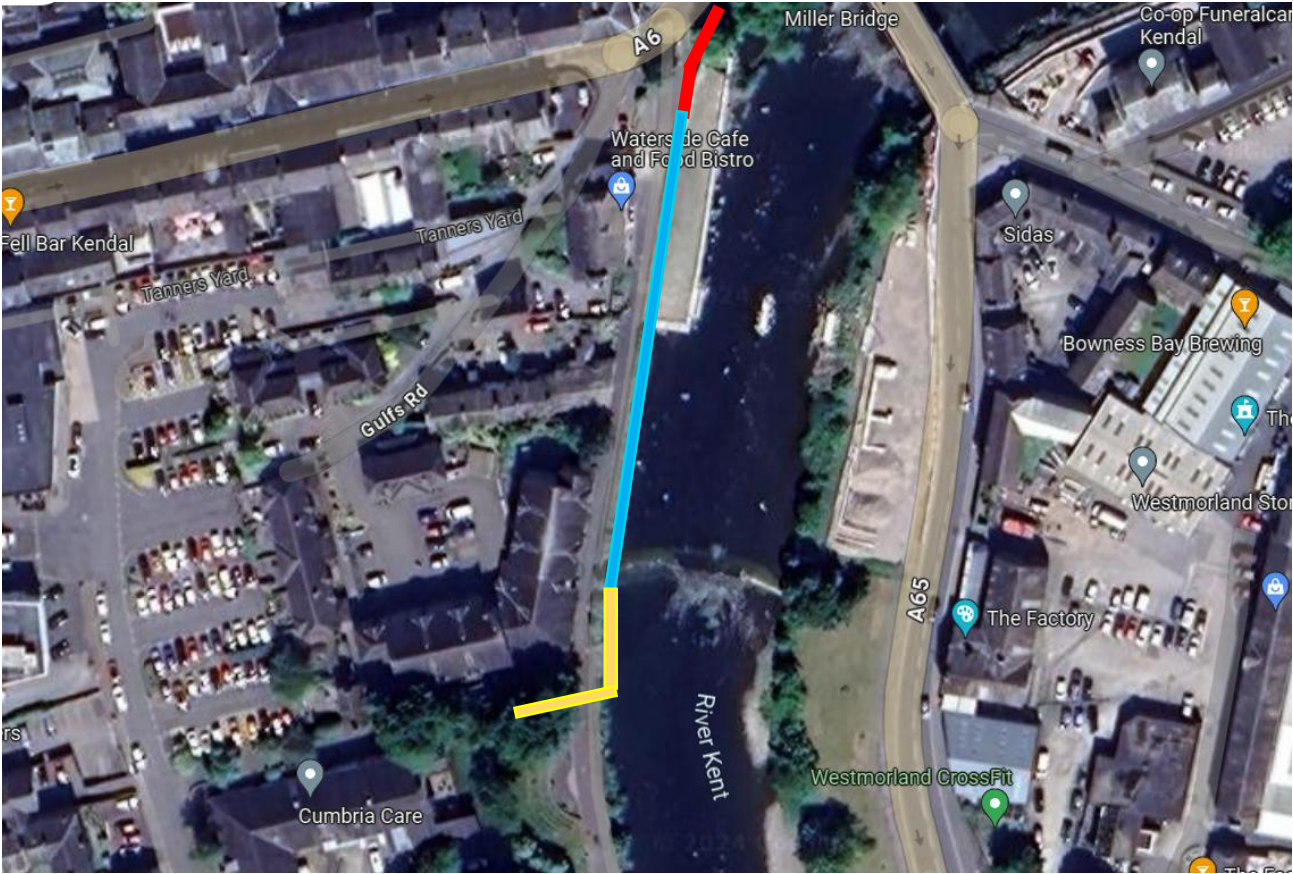

Waterside Café area



Central Waterside

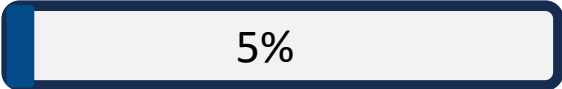

Edgecombe Court area

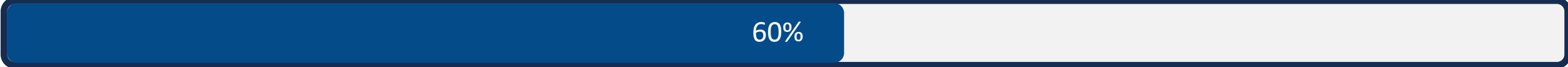

Kendal Flood Risk Management Scheme

Protecting the Environment

An Independent Ecological Clerk of Works will monitor all activities and will have a regular presence on site over the coming months. This is an important role that oversees all site preparation and construction works associated with biodiversity. This is to ensure safe working, and protection of the local environment is undertaken in accordance with legislation and best practice.

Pre-construction surveys have been carried out and include, but are not limited to; otters, breeding birds, invasive non-native species, trees and white-clawed crayfish as well as many other species such as salmon. Spawning grounds are known and monitored in respect of salmon and trout on all rivers and tributaries within the Kent catchment.

Full consideration has been given to the in-river working platform and bank stabilisation bags. Consent has been granted for these works to be undertaken and will be monitored by our Independent Environmental Clerk of Works.

All our activities around, or near European Protected Species are carried out under licence, and we will put in place measures to mitigate against impacts from any of our works. We will install environmental monitoring which will monitor noise, vibration and vehicle movements in sensitive locations so we can take further measures to mitigate against any risk of environmental harm.



White Clawed Crayfish



Otter



Kingfisher

